

# Wireless Digital Room Thermostat

---

This smart thermostat has been developed to be able to switch electric and conventional heating systems on and off using a set temperature and time remotely at anytime anywhere.



## Functions

---

- ✓ Amazing Mirror Effect Display
- ✓ Large display can be clearly read with the background lighting.
- ✓ Easy to fit thermostat and receiver.
- ✓ Five buttons make it easy to use.
- ✓ 4 periods of each day programmable
- ✓ The display shows the set temperature as well as the measured temperature, time.
- ✓ Temperature display in degrees Celsius.
- ✓ The thermostat is supplied with a wall-fixing frame, base and a very compact receiver (surface-mounted).

## Technical Data

---

Thermostat operating voltage:	2*AA battery power or USB; 5V/1A
Backup storage:	EEPROM
Receiver operating voltage:	230 VAC, 50/60 Hz
Maximum voltage / (ohmic) load:	250 VAC/10 A.
Frequency:	868 MHz
Channel selection:	By programming the thermostat and the receiver.
Switching options:	7 days, 4 periods each day.
Receiver switch contacts:	NO and NC.
Temperature settings:	5°C ~ 35°C, 0.5°C increments.
Accuracy:	+/- 0.5°C
Thermostat dimensions:	Surface mounted, 125*98*23.5MM
Receiver dimensions:	Surface mounted, 90* 90*26 mm
Color:	White
IP protection rating:	20.
Certification:	CE, Rohs, RED

# Wireless Digital Room Thermostat

## Display

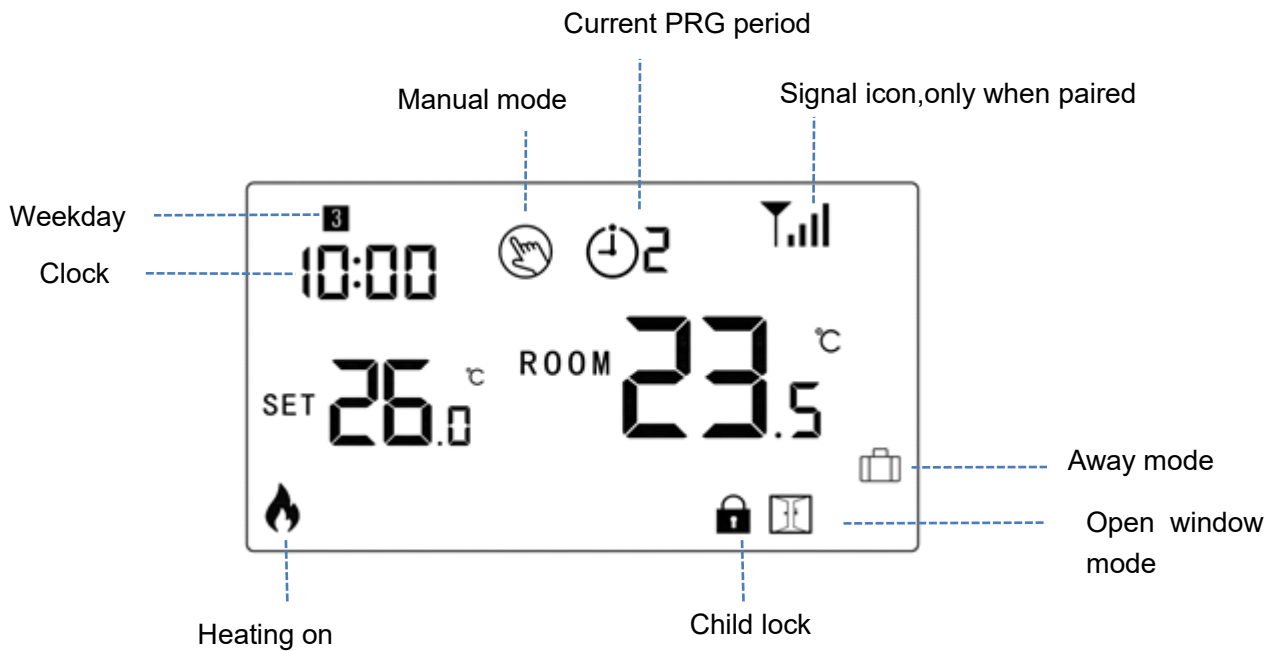

## Code Pairing & WIFI Connection

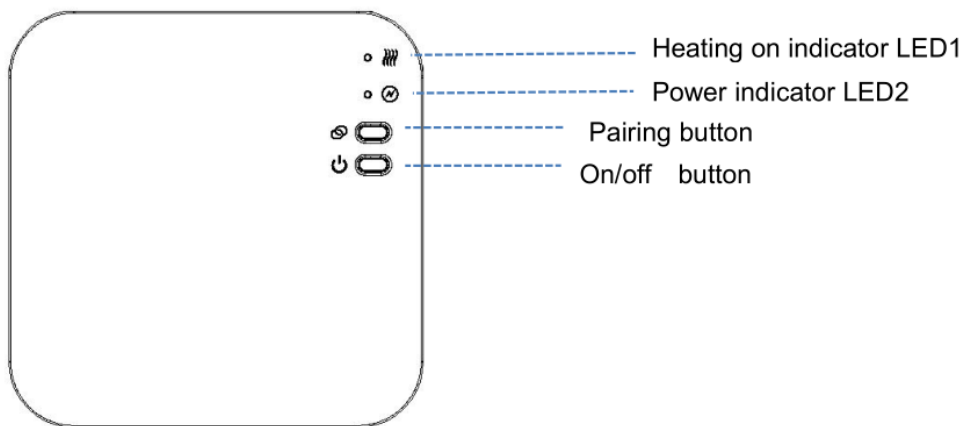

### I. Code Pairing with Sender

- 1) Long press the code pairing button on the receiver until LED 1 is flickering quickly.
- 2) Turn off thermostat and long press **M** button until the code shows on the screen, then press  button.
- 3) Wait for a while, LED 1 stop flickering, code pairing successful.

# Wireless Digital Room Thermostat

## II. WIFI connection with App

- 1) Scan the QR code, and download “Smart Life” APP from google play or app store
- 2) Install app and register account, make sure you phone in same 2.4G WIFI as device.
- 3) Add device by press + button at top right corner
- 4) Press “ Small Home Appliances ”
- 5) Find “ Thermostat (Wi-Fi)” on the list and press
- 6) Long press the **Pairing button** on the receiver until LED 1 is flickering quickly.
- 7) Choose “ EZ mode” on top right corner of app
- 8) Tick “Confirm indicator rapidly blink” on phone.



Wait a moment till LED1 stop flashing. Wifi connection successful.



## III. Clear all pairing

Long press both code pairing button and On/Off button for 5 seconds, LED1 and LED2 will flicker once at the same time, codes pairing are eliminated.

## IV. Signal Lost



In case the RF and WIFI signal lost/disconnected, LED 1 will flicker slowly.

## Clock Adjustment





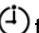

Press and hold **M** button for 3s, set the clock and pre-set temp. of each mode by pressing  and  button, each press of **M** button will go to next item setting.

Menu	Description	Menu	Description
01	Clock setting- Minute	03	Clock setting- Weekday
02	Clock setting- Hour		

## Mode Select



Press **M** button to switch mode from PRG mode  to absent mode  or Manula mode .

### Notes:

- 1) If thermostat works at PRG mode , you change set temperature by pressing  and  button, it only works as temporarily set temperature, it will not be kept at next period.
- 2.) If thermostat works in absent mode  or Manual mode , you change set temperature by pressing  and  button, the new set temperature will be kept for next time usage.

## PRG setting

Press and hold **P** button for 3s to enter program setting.

Set the schedule (Weekday-Period-Start time-Temp.) by pressing  and  button, each press of **P** button will go to next item setting.

# Wireless Digital Room Thermostat

## Default Setting:

Period	1		2		3		4	
	Time	Temp	Time	Temp	Time	Temp	Time	Temp
12345(Mon.~Fri.)	7:00	22°C	8:30	19°C	17:00	22°C	22:00	19°C
6(Sat.)	8:00	22°C	8:30	22°C	17:00	22°C	22:00	19°C
7(Sun.)	8:00	22°C	8:30	22°C	17:00	22°C	22:00	19°C

## Temperature Calibration

This feature used to calibrate thermostat's room temperature display when actual room temperature different from thermostat showed (refer to the menu 01 of parameter settings). For example, if actual room temperature 21.5°C, but thermostat shows 23°C, then you can set this value to -1.5, then radiator thermostat will show 21.5°C.



## Frost Protection

This is the temperature maintained when the thermostat is in Frost Protection Mode (refer to the menu 05 of parameter settings). If room temperature below 5°C (Default), radiator thermostat will turn on heating till room temperature arrive 5°C (Default).

## Switching Differential

This function allows you to increase the switching differential of the thermostat (refer to the menu 09 of parameter settings). The default is 0°C which means that with a set temperature of 20°C, the thermostat will switch the heating on at 19.5°C and off at 20.5°C. With a 0.5°C differential, the heating will switch on at 19°C and off at 21°C.

## Child Lock

Under child lock ON (refer to menu11 of parameter setting), the buttons will lock once backlight off. Press  and  button at the same time for 5s to unlock it for temporary adjust.

## Open Window Detection(OWD) Function

When the Open Window detect function is enabled in the parameter setting, the system will automatically stop heating when it detects a sudden drop of room temperature (2°C in 15 minutes as default). This is normally caused when a window or door is opened without turning off the heating device.



The device will return to the previous mode of operation after 30mins, then  disappear. Press any button will exit OWD function during the heating off period.

# Wireless Digital Room Thermostat

---

## Parameter Setting

---

Turn thermostat off, press and hold **M** button and  button for 6s to enter parameter setting. Each press of **M** button will go to next item setting. Adjust the value by pressing  or  button.

<u>Menu</u>	<u>Description</u>	<u>Range</u>	<u>Default Value</u>
01	Temp. calibration for internal sensor	-8 °C ~8 °C	0°C
02	Set Point Max.	5 °C ~35°C	35 °C
03	Set Point Min.	5 °C ~35°C	5 °C
05	Frost Protection Temp.	5 °C ~15°C	5 °C
09	Dead zone	0~3°C	0°C
11	Child Lock	1: Lock 0: Unlock	0
12	Open window detect function	OFF ON	OFF
13	OWD Detect Time	2~30mins	15mins
14	OWD Drop temp. select (within detect time)	2.3.4°C	2 °C
15	OWD Delay time select (Return to previous working status)	10~60min	30mins
17	Factory reset	1: Yes, and then press On/off button for 5 seconds until thermostat restart	0
	Software version	Read Only	
	Software version	Read Only	
31	WIFI Information	Read Only	
32	Standby Mode Brightness Adjust (When USB Power Only)	0~100%	40%

## Wiring Diagram

---

# Wireless Digital Room Thermostat

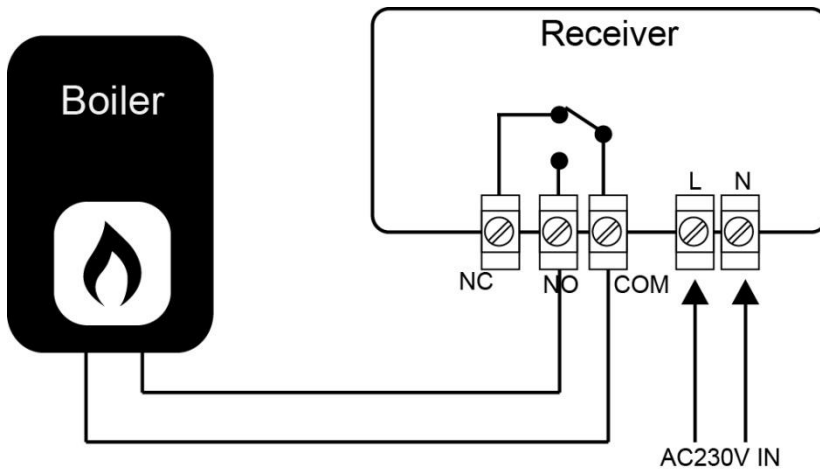

## Installation & Size

### Installation Thermostat on Wall:

1. Carefully separate the front half of the thermostat from the back plate by placing a small flat head terminal driver into the slots on the bottom face of the thermostat.
2. Mark 2 hole positions on the wall using the back plate as a positioning template. Drill at the marked positions and insert a wall plug into each hole. Screw the thermostat back plate securely on the wall.
3. Remove the battery cover, and insert the batteries. ( If Wi-Fi version, then will be USB power supply, not battery request)
4. Clip the front of the thermostat back onto the thermostat back plate.

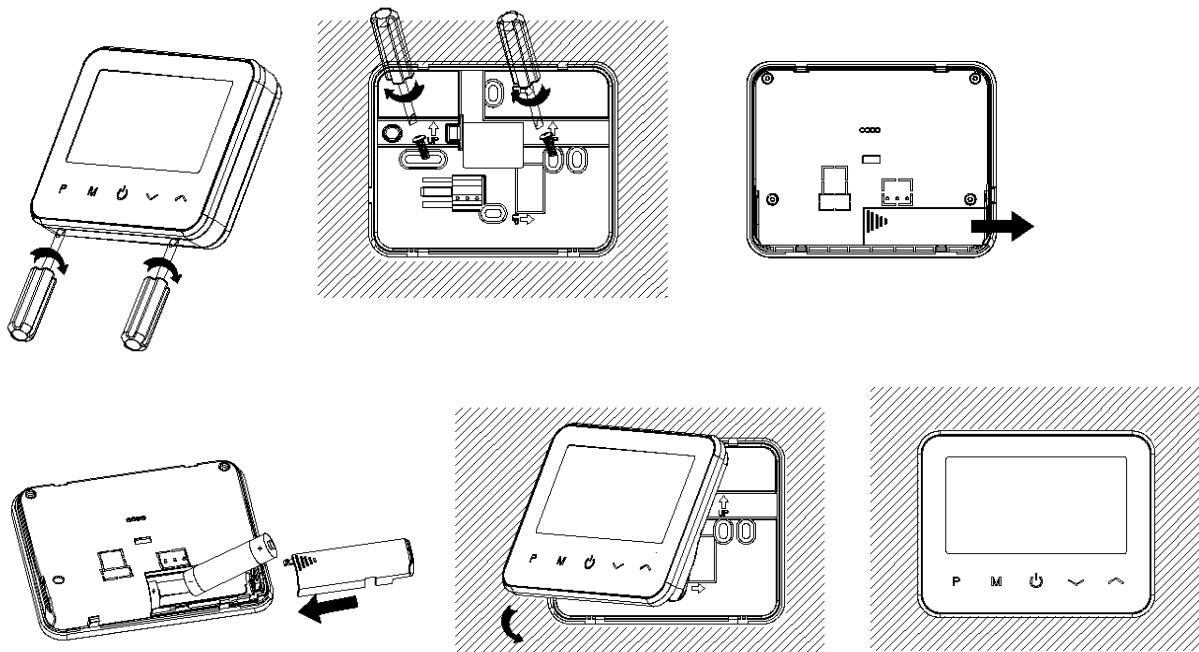

### Put Thermostat on Desk:

1. Carefully separate the front half of the thermostat from the back plate by placing a small flat head

# Wireless Digital Room Thermostat

terminal driver into the slots on the bottom face of the thermostat.

2. Clip the front of the thermostat onto the provided holder.

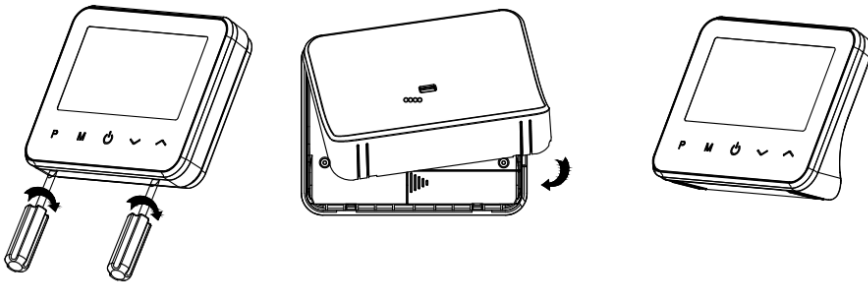

## Installation Receiver:

1. Using a small screwdriver, slightly loosen the screw located at the base of the RF-Switch. You can then carefully separate the front panel from the back plate.
2. Position the RF-Switch back plate on the wall, fixing into place using the screws provided.
3. Terminate the cables to the RF-Switch as shown in the wiring diagram
4. Mount the front panel onto the back plate, tighten the retaining screw on the base.
5. Switch on the power supply, the power LED will illuminate.

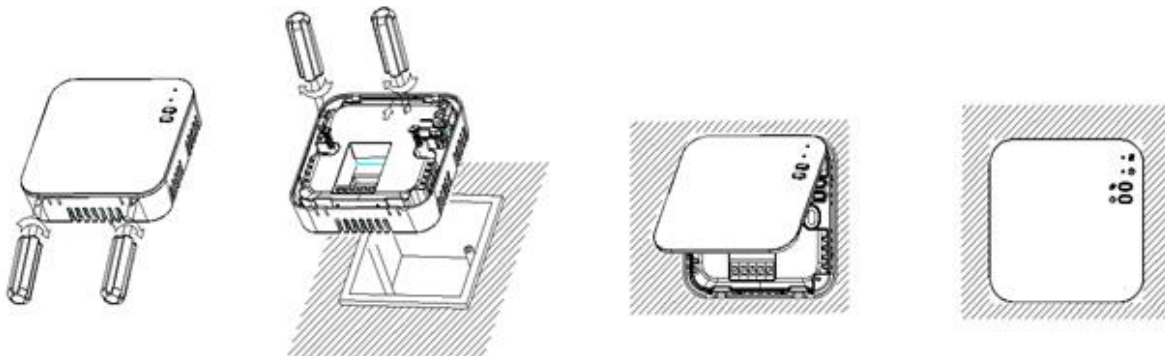

## Size:

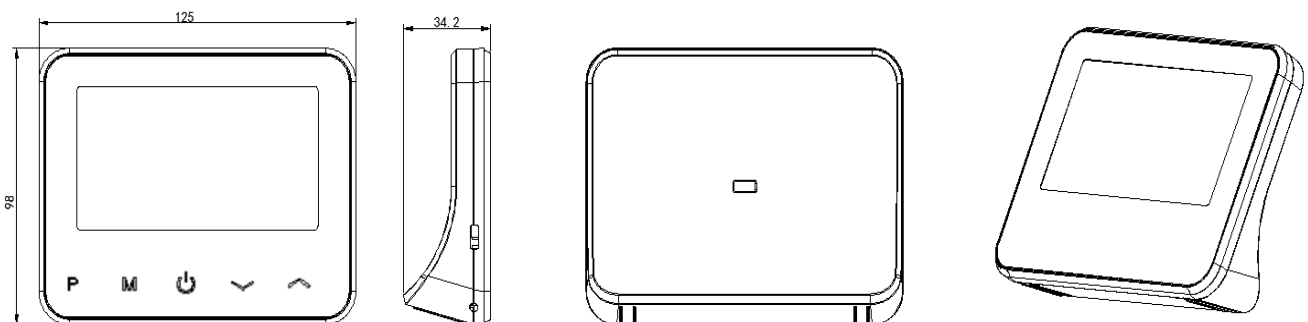

# Wireless Digital Room Thermostat

---

