



Constant temperature controllers **PROMATIC ACC**

PROMATIC ACC compact controllers are integrated into the actuator housing and are intended for regulation of the constant temperature of the flow or return line. Most frequently, they are used for regulation of the return temperature of solid fuel furnaces and charging of the hot water buffer tank, heating of swimming pools, as well as other heating and cooling systems.



Product range

PROMATIC ACC30

PROMATIC ACC40

HIGHLIGHTS

- Fits onto more than 20 different valves.
- Simple installation and setting.
- Adjustable return pipe temperature.
- LEDs to show rotation direction.
- Built-in actuator.

Introduction

The PROMATIC ACC compact controller is designed to control a constant flow and return line temperature. It is integrated into the actuator housing.

It is used for regulating the return temperature of solid fuel furnaces and charging the hot water buffer tank, to control the supply temperature for swimming pools, as well as other heating or cooling systems.

The PROMATIC ACC controller is simple to install and use. The configuration is done by means of a capacitive keypad that is resistant to mechanical impacts, moisture, and dust.

Installation of PROMATIC ACC on the mixing valve

The compact design of the controller allows for quick and easy installation and reliable operation.

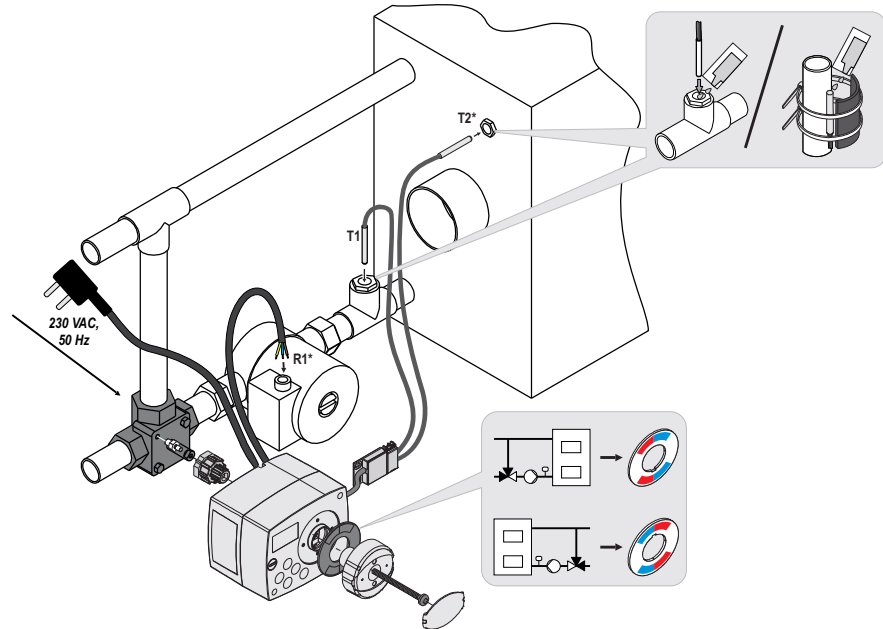

Junction box for sensors



Innovative solution for quack and reliable sensor installation.

Compatible with mixing valves



PROMATIC ACC controllers can be mounted on a wide range of mixing valves from different manufacturers. For this purpose various installation sets are available.



Features

PROMATIC	ACC30	ACC40
Number of hydraulic schemes	4	4
Number of storage tanks	1	1
Number of mechanical relays	0	1
Number of electronic relays	2	2
Number of temperature sensors	1	2
Signalisation of the valve rotation direction	•	•
Animation of the activated circulation pump		•
Heating system protection		
Overheating protection for boiler, collectors and storage tank	•	•
Anti-block function for pumps and valves		•
Data display		
Display of hydraulic scheme	•	•
Graphic overview of temperatures	•	•
Logging of settings changes	•	•
Error and high temperature warning	•	•
Settings and installation		
Multilingual user interface	•	•
Simple adjustment of operating modes by selection of hydraulic scheme	•	•
Installation sets for many mixing valves	•	•
Adjustment of rotation direction of the actuator	•	•
Easy installation and connection	•	•
Remote access		
Possibility of connection with PC	•	•

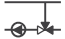
Regulated elements

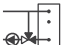
PROMATIC		ACC30	ACC40
	Control of constant stand- or return- pipe temperature	•	•
	Heat accumulator warming	•	•
	1-phase storage tank loading	•	•

Technical data

PROMATIC	ACC30	ACC40
Power supply	230 V ~, 50 Hz	
Consumption	< 2 VA	
Consumption in standby mode	max. 0.25 W	
Relay output	4 (2) A / 230 V~	
Triac output	0.1 A / 230 V ~	
Torque	6 Nm	
Degree of protection	IP42 acc. to EN 60529	
Safety class	I acc. to EN60730-1	
Operation type	1B acc. to EN 60730-1	
Temperature sensor type	Pt1000	
Mixing valve control	3-point PID	
Controller housing	PC - thermoplastics	
Dimensions (w × l × h)	84 × 101 × 88 mm	
Ambient temperature	0 ÷ 40 °C	
Storage temperature	-20 ÷ 65 °C	
Weight	668g	848g
Package unit	12 pcs	

Dimensions

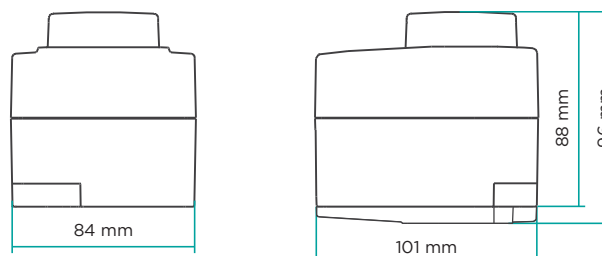

Hydraulic schemes

PROMATIC ACC30, ACC40

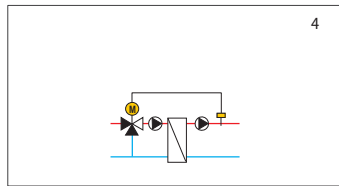
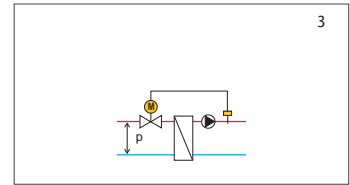
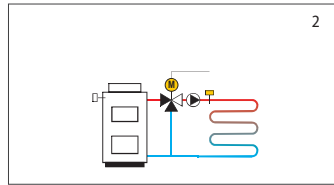
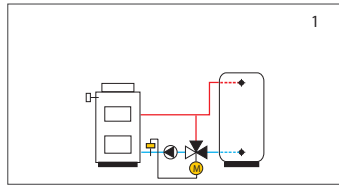

PROMATIC ACC40

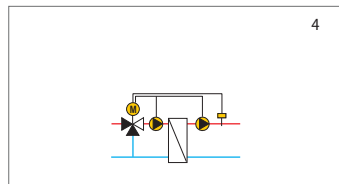
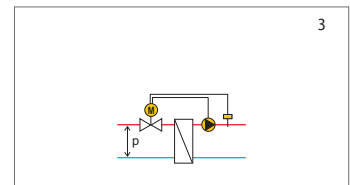
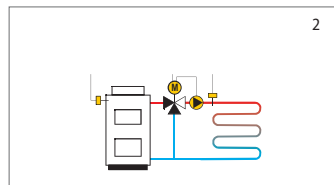
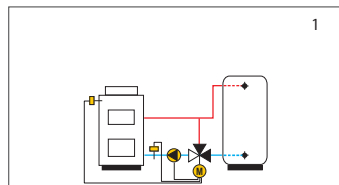

Ordering codes

	Code	Description
	1ACC301-NN0	Constant temperature controller PROMATIC ACC30 incl. 1xTF/Pt
	1ACC4011-NN0	Constant temperature controller PROMATIC ACC40 incl. 1xTF/Pt
	1TFPTC3MP+000	Immersion sensor TF/Pt, with 3.5 mm plug, 3 m - Neutral

Installation sets for controllers PROMATIC ACC

	Code	Description
	1ASCAVMSA000+NN0	Esbe, Seltron, Somatherm, Acaso, IVAR, WIP, PAW, BRV, IMIT, Hora, Barberi, Olymp, Hoval
	1ASCAVMSB000+NN0	for 10Nm+ Esbe, Seltron, Somatherm, Acaso, IVAR, WIP, PAW, BRV, IMIT, Hora, Barberi, Olymp, Hoval
	1ASCAVMSC000+NN0	Centra ZR/DR
	1ASCAVMSD000+NN0	Centra DRU
	1ASCAVMSE000+NN0	Siemens VBI, VBF
	1ASCAVMSF000+NN0	Wita, Meibes
	1ASCAVMSG000+NN0	Esbe VRG
	1ASCAVMSH000+NN0	Firšt
	1ASCAVMSI000-NN0	Honeywell V544, ..., V543
	1ASCAVMSJ000-NN0	Paw K32, K33, K34
1ASCAVMSK000+NN0	Danfoss HRB, HFE, HRE	